

## P-System joining elements

### Clamex P



#### Properties and advantages

- **Detachable connection** for ready-to-assemble furniture
- **Installation within seconds**, by hand without tools
- **Joins and aligns**, 2 functions in one connector
- **Downright aesthetic** due to the small opening (Ø=6mm) to close and open the connector
- **Safe from twisting** due to the studs
- **Mitre joints in all angles** are possible
- **Stackable** since no parts protrude the surface
- **Simple cutting process** with Lamello Zeta
- **Installation tolerance** lateral +/- 1.0 mm (max. +/- 1.5 mm)

#### Applications

**Workshop:** Detachable furniture, interior fitting, mitre joints, frame connections, door frames, all kinds of connections

**On site:** Glue aid, claddings, all kinds of installations



fast



aesthetic

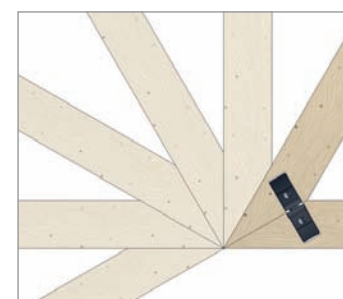

flexible

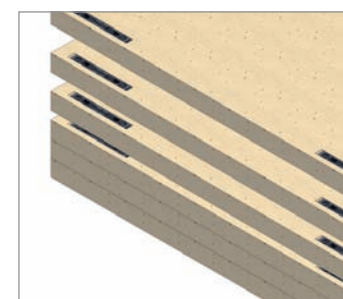

stackable

### How it works



1. Cut the profile groove with the Lamello Zeta



2. Slide the drill jig into the groove and drill the access hole



3. Slide the connector by hand into the groove within seconds - without tools



4. Assemble the workpieces and close the connections - that's it

### Bisco P



#### Properties and advantages

- **Ideal addition to Clamex P**, fits into P-System grooves to avoid tool change
- **Align P-System grooves** with or without glue
- **Use as joining element due to its surface structure** when glueing with PVA glue
- **Lateral tolerance** +/- 2mm

#### Applications

Separating walls, furniture with large depth, gluing of workpieces

## Important information

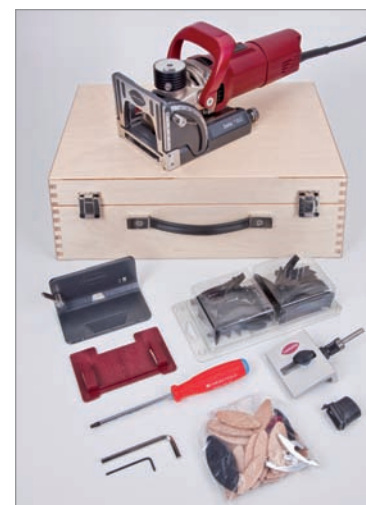

#### Zeta-Set

##### Kit contains

- Machine
- Stop square
- Suction stub 23 mm
- Suction stub 36 mm
- Spacer 4 mm
- Tools
- Drill jig incl. drill for Clamex P
- 18 Clamex P connectors
- Wooden case

##### Art. Nr. 101400

with carbide tipped profile groove cutter

##### Art. Nr. 101400D

with diamond tipped profile groove cutter

#### Technical data

|                     |                                       |
|---------------------|---------------------------------------|
| Power:              | 800 W                                 |
| Version:            | 230 V                                 |
| Speed:              | 9000 min <sup>-1</sup>                |
| Cutter:             | HW-Profilnutfräser<br>100 x 7 x 22 mm |
| Teeth:              | Z3                                    |
| Cutting depth max.: | 20 mm                                 |
| Weight:             | 3,7 kg                                |

#### Guaranty of supply

10 years on spare parts and accessories

#### Clamex P connector

Material: Fibreglass reinforced plastic  
Size: 66 x 29 x 10 mm  
Installation tolerance: lateral ± 1 mm

- Box with 80 pairs **145337**
- Box with 300 pairs **145342**
- Box with 1000 pairs **145352**

#### Bisco P aligning element

Material: plastic  
Size: 65 x 27 x 7 mm  
Installation tolerance: lateral ± 2 mm

- Box with 80 pieces **145301**
- Box with 300 pieces **145302**

Manufacturer:

**Lamello AG**  
Joining technology  
Hauptstrasse 149  
CH-4416 Bubendorf  
Tel. +41 (0)61 935 36 36  
Fax +41 (0)61 935 36 06  
info@lamello.com  
www.lamello.com



Swiss made



## Zeta

The most advanced biscuit joiner saving you time daily

With unique **profile groove function** to install Clamex P

### P-System

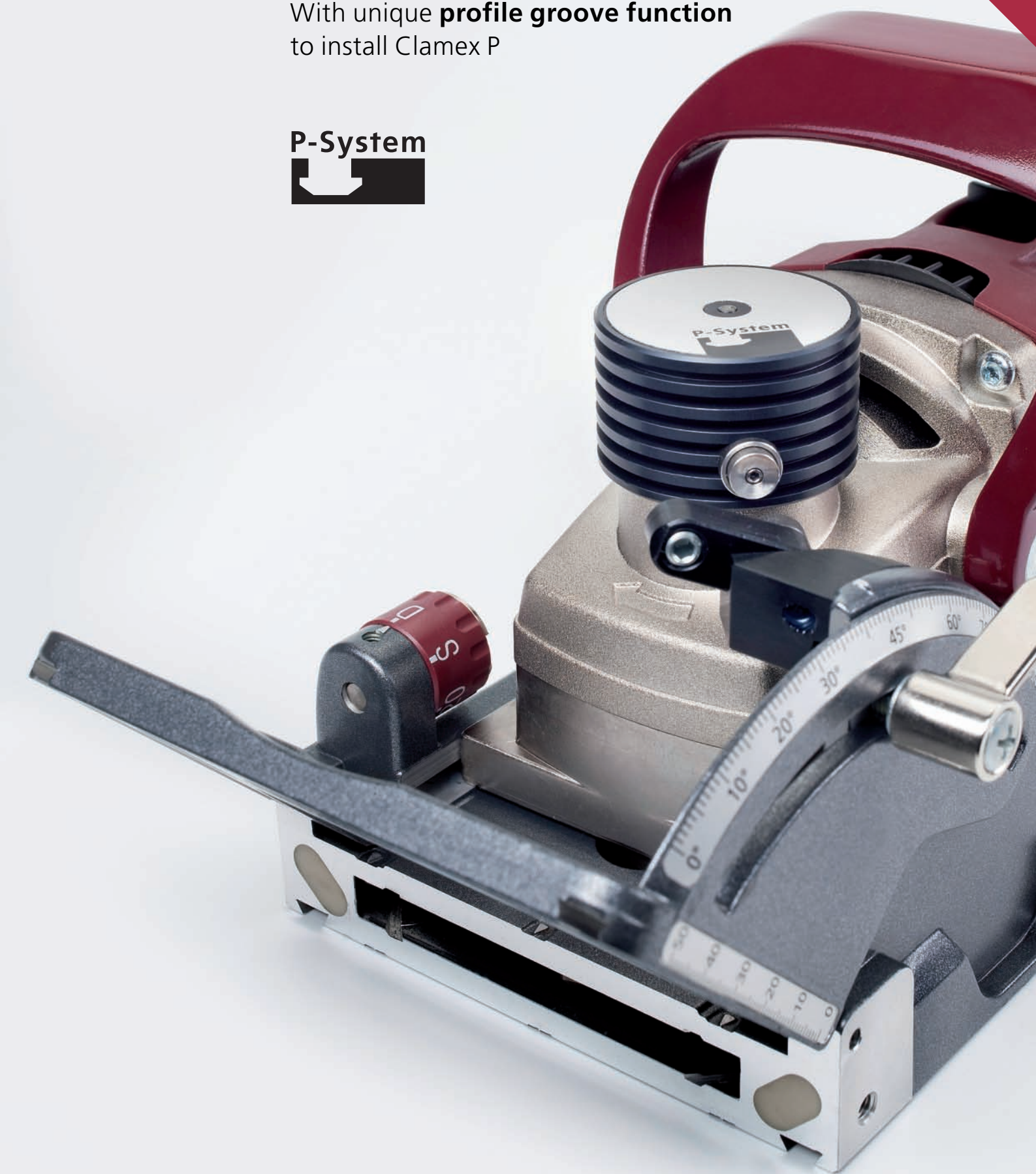

New

## Profile groove function

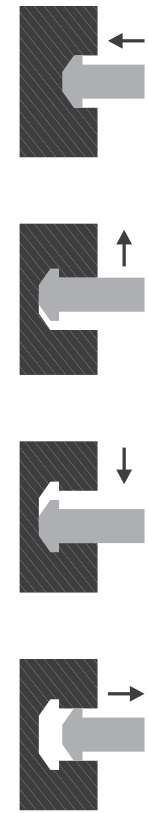

The vertical mechanical drive (VMD) is the core of the machine and the key to the P-System, the new joining system with profile

### The cutting procedure

The cutter dives in to the preset depth. Then follows a vertical movement up and down for the profile cut

### Properties and advantages

#### User-friendly

- triggers the **vertical movement automatically**
- **low weight** due to the compact build
- **optical VMD control**

**Safe process** using reliable, mechanical low-wear technology

**Switch off the VMD** to use the machine as standard biscuit joiner using it for 14 more applications



## Motor

- **Powerful 800 W motor** with electronic control
- Soft start, speed control, start protection
- **Maintenance friendly**, minimal cost for maintenance and repair

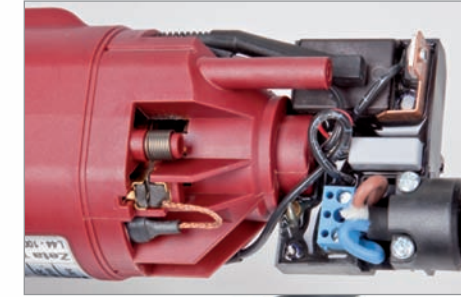

## Lamello Zeta is the right investment into your future

### 3 reasons why the investment pays off

#### 1. Time saving with every groove!

**Lower** your largest expenditure which is **labour cost** and **improve** your **profit!**

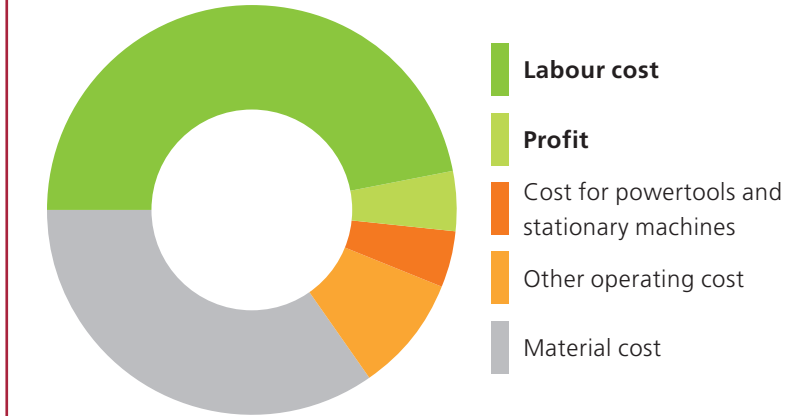

- **fast, easy and precise** working, with the well-established Lamello principle
- **same cutting depth for both workpieces**, saves the time for changing the setting and makes mistakes less likely
- **Time saving when installing fittings** due to the innovative profile groove concept which saves labour cost as well as the cost for glue or screws
- **Future time saving** with every new joining element of the P-System family

#### How long does it take to make a joint?

Approx. 2mins for a corner connection with 2 connectors including:

- cutting 4 profile grooves
- drilling 2 opening holes
- sliding in 4 connector halves
- assembling and tightening the joint

#### 2. Differentiation

- **modern design** with detachable mitre joints
- **aesthetic solutions** due to the tiny access opening

#### 3. Additional use

You can switch off the VMD and use the Lamello Zeta as a **standard biscuit joiner with 14 more applications\***. For example **to cut the groove for the original biscuits 20, 10, 0.**



\* Change the cutter for 4mm grooves, H9, Minispot and expansion gaps

## Base plate

### Long-life precision guidance

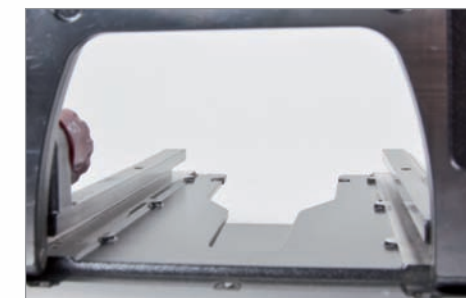

rendering precise, parallel grooves for **perfect alignment of the workpieces**

### Machined high-precision reference surfaces

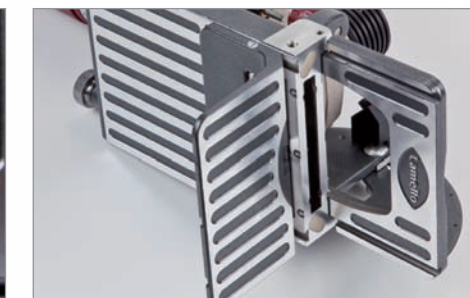

for **accurate applying** on the workpiece

### Reference surface on the side of the base plate



- base plate, swivelling front stop and stop square are **flush on both sides**
- for **efficient positioning** of the machine on the edge of the workpiece

### Multifunctional stop square



- **outside flush** mitre joints with workpieces of varying thickness
- **135° mitres**
- **larger surface** when working vertically

### VMD trigger



pivoting trigger to switch off the VMD function to use as **standard biscuit joiner**

**Swivelling front stop 0-90** catching at 22.5°, 45°, 67.5°

Rotating depth adjuster with **6 standard depths**

**Central locking** for **fast cutter changing**

**Extra slim anti-slide pads** for **good grip**